



# THE ZEPP COMPANY

Commercial Real Estate

www.zeppcompany.com

214.676.3709

# PROPERTY FOR SALE OR LEASE

## Midway Industrial Park

2717 Fallon Dr., Sherman TX  
Zoned Commercial / Industrial



### 2717 Fallon Dr

Size: 21,000 SF / Built 1995  
Metal Building

2, 14' Dock High Doors

2, grade level doors

18' -21' Clear

3 offices/ 3 Bathrooms

Electric, Gas, Water

No Sprinklers or Security

Power: 3 Phase 480

**Base Rent/NNN \$3.60**

\$3.10 plus NNN (\$.50/psf)

**For Sale \$485,000**

### 2812 Fallon Dr

Size: 23,000 SF

5,000 SF Occupied / \$1400/mo.

Vacant: 18,000 SF / Built 1970

Metal Building / 8 Dock Doors

1 Grade Door

18'-20' Clear / 2 Bathrooms

Insulated / Electric, Gas, Water

3 Phase 460

**Base Rent/NNN \$3.60**

\$3.10 plus NNN (\$.50/psf)

**For Sale \$565,000**

**Katina Zepp \*\*\*\*\***

214.676.3709

katina@katinazepp.com

**FOR INFORMATION**

**Bill Godwin \*\*\*\*\***

214.356.5244

wwgodwin@gmail.com

# Midway Industrial Park

2717 Fallon Drive, Sherman, Texas 75090

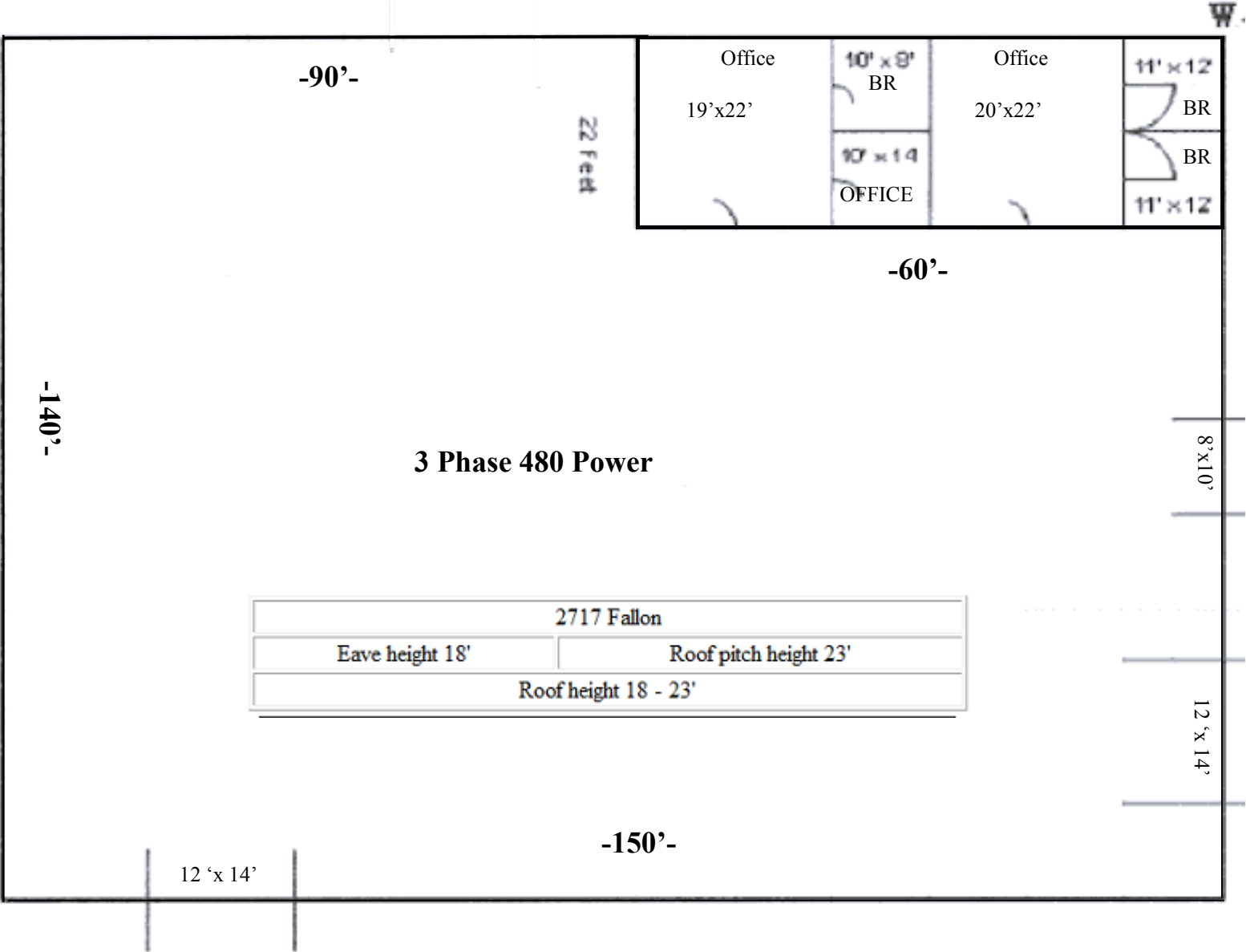

Taxes \$6000  
 Insurance \$3000

# 2812 Fallon Drive Sherman, Texas

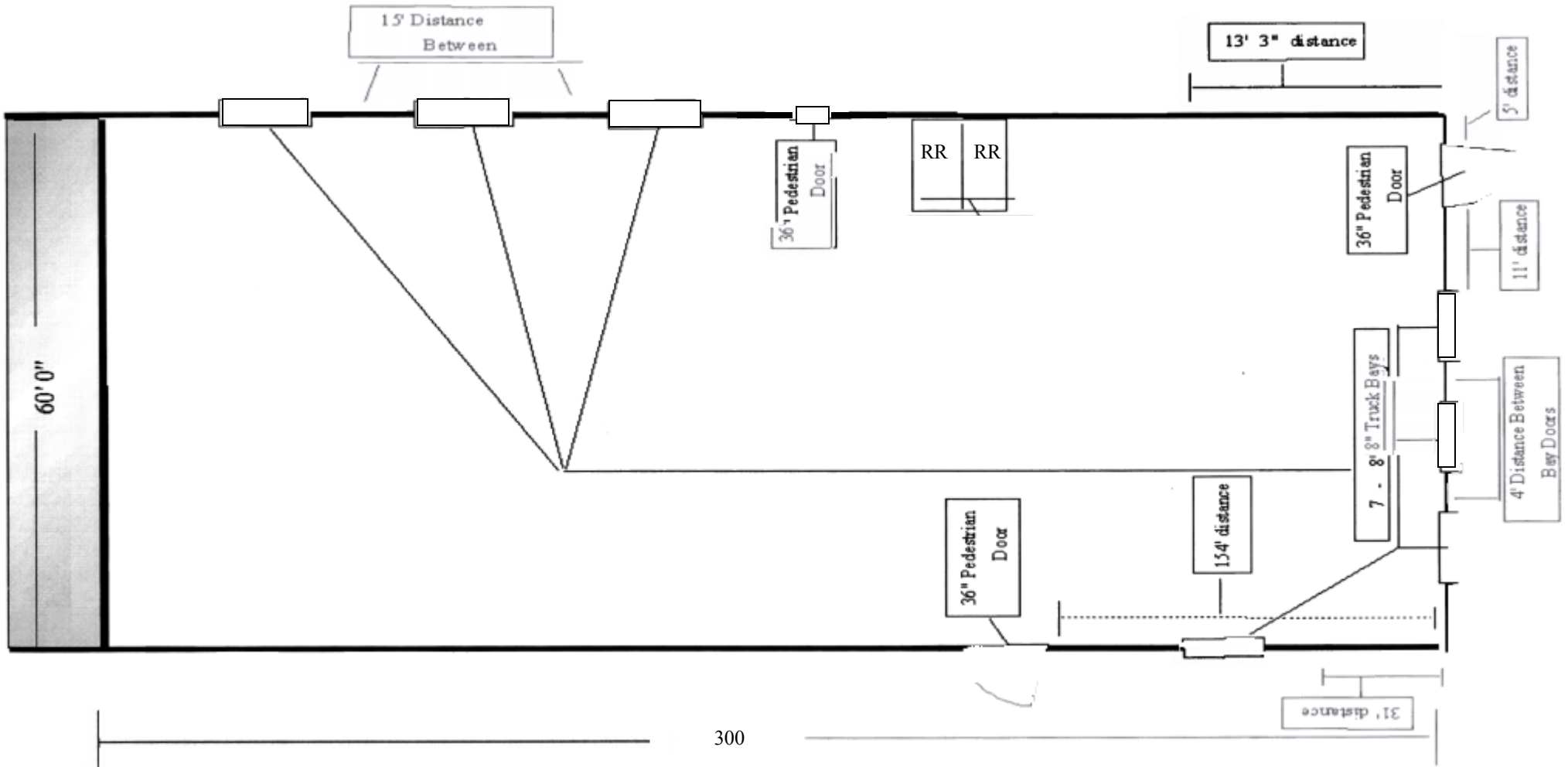

**Additional 5000 SF brings \$1400/per month Building Taxes \$4800 & Insurance \$3000**  
**Note: piped drains which go under the bldg and are routed to open area by RR tracks.**

## Fallon Drive Property Zoned Commercial Industrial

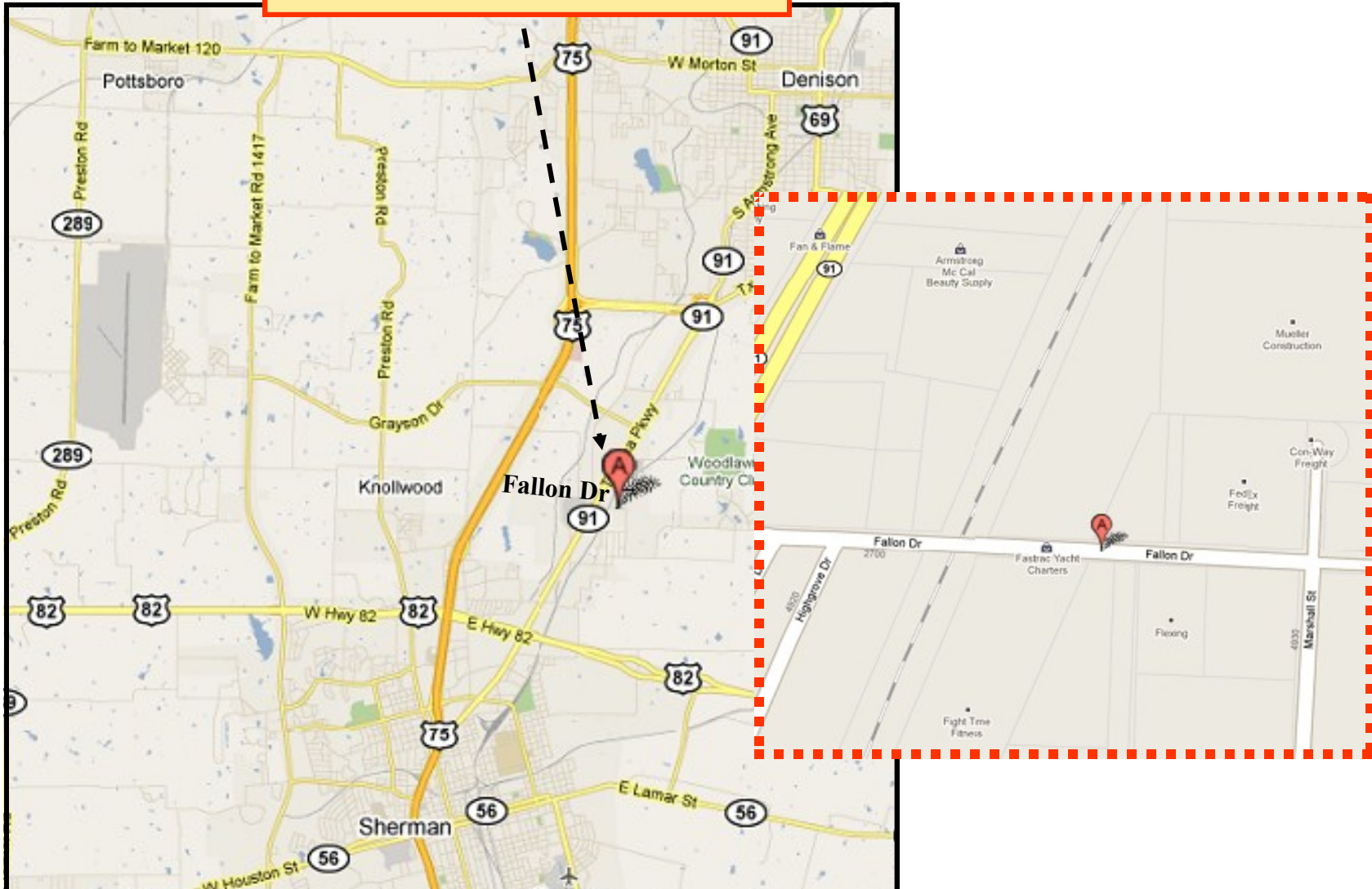

**THE ZEPP COMPANY**  
Commercial Real Estate  
[www.zeppcompany.com](http://www.zeppcompany.com)

Information furnished, while obtained by sources believed reliable, has not been verified by The Zepp Company; we make no guarantees, warranty or representation as to its accuracy and completeness. It is submitted subject to independent investigation by you, without reliance on us. This submission is subject to change in price, prior to sale or withdrawal without notice.